

Feature Updates in TIMESPAY System

TIMES
SOFTWARE

Feature Updates

- 1 Payroll Department Report (Excel)
- 2 IBG File Transfer
- 3 Auto-Setup Employee's Statutory Class
- 4 Creating New Code in TIMESPAY

Payroll Department Report (Excel)

Management Reports >

Payroll Department Report (Excel)

- Added fields:
Wages of EPF, SOCSO, EIS, PCB Y1, PCB YT, and HRD.

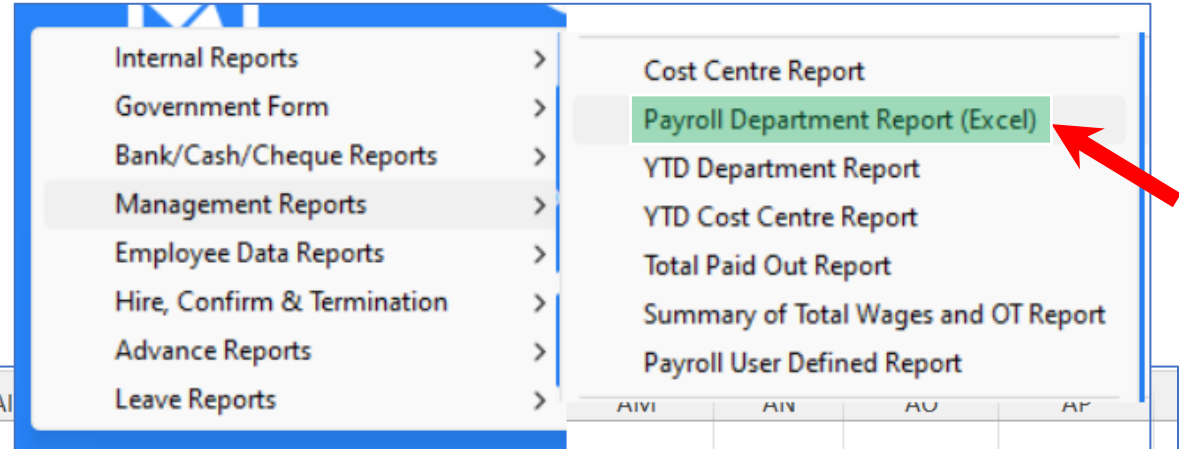

Payroll User Defined Report													
Leave Reports						AI	AI	AI	AI				
1	YEAR END WORKSHOP												
2	Payroll Details Breakdown Report 202412												
3	Month : End Month												
4													
5	Department	Department Name	Cost Centre	Cost Centre Name	Employee No.	HRD	EPF WAGE	SOCSSO WAGE	EIS WAGE	PCB Y1	PCB YT	PCB WAGE	HRD WAGE
6	JBA	JURU - ADMIN	NONE	NONE	Z0001	9.00	940.00	940.00	940.00	900.00	0.00	900.00	900.00
7	JBA	JURU - ADMIN	PJ	PETALING JAYA	Z0004-A	0.00	10,000.00	10,000.00	10,000.00	10,000.00	0.00	10,000.00	10,000.00
8	JBA	JURU - ADMIN	PENANG	PENANG	Z0007	100.00	10,800.00	10,800.00	10,800.00	10,800.00	0.00	10,800.00	10,000.00
9	Sub Total:					109.00	21,740.00	21,740.00	21,740.00	21,700.00	0.00	21,700.00	20,900.00
10	JBM	JURU - MARKETING	BB	BUKIT BINTANG	D001	0.00	5,000.00	5,000.00	5,000.00	5,000.00	0.00	5,000.00	5,000.00
11	JBM	JURU - MARKETING	JOHOR	JOHOR	G001	150.00	15,000.00	15,000.00	15,000.00	15,000.00	0.00	15,000.00	15,000.00
12	JBM	JURU - MARKETING	PENANG	PENANG	Z0004-C	0.00	2,033.71	2,033.71	2,033.71	2,033.71	0.00	2,033.71	2,033.71
13	JBM	JURU - MARKETING	BB	BUKIT BINTANG	Z0000	55.00	5,480.00	5,480.00	5,480.00	5,250.00	2,480.00	5,730.00	5,500.00

IBG File Transfer

When no data is available to generate, the system will now display an alert message instead of creating a file with empty details as it did previously.

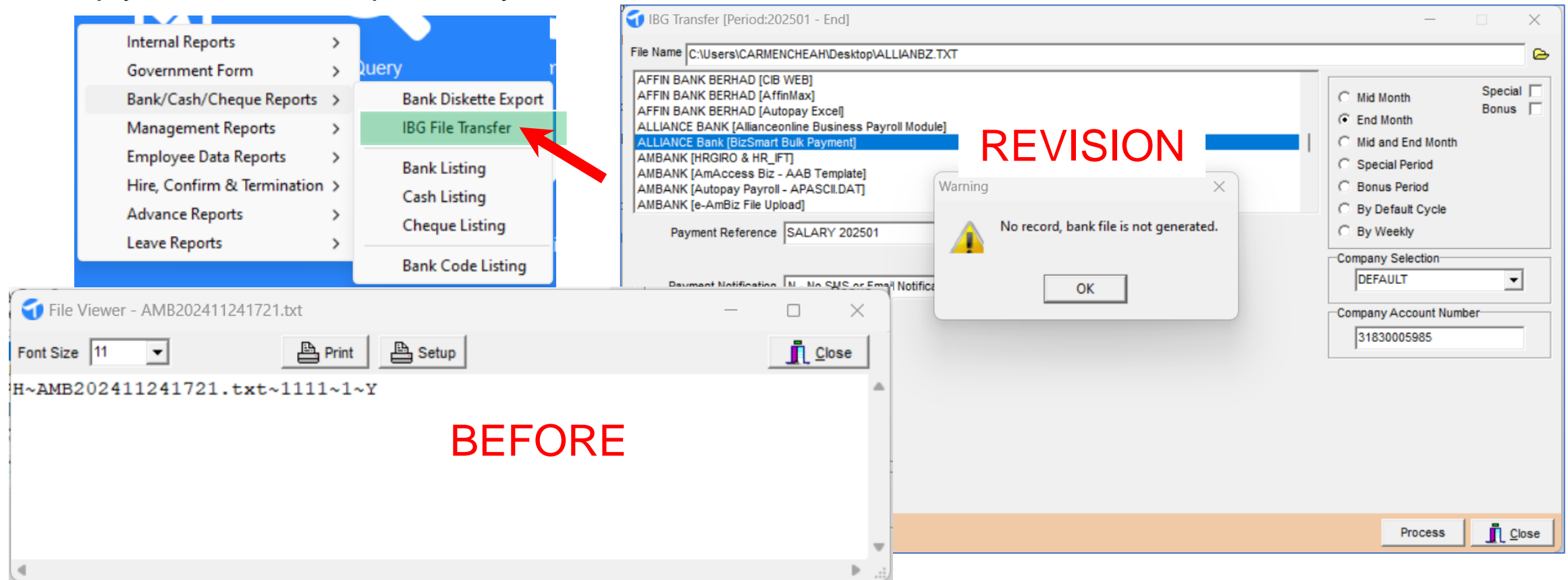

IBG File Transfer

For customers with multiple companies in one database, you can now generate the bank file by selecting the specific company code from the **Company Selection** dropdown.

Note: You can still use the previous method, **Query Company**, if preferred.

The screenshot shows the 'IBG Transfer [Period:202411 - End]' window. The 'ame' field contains 'C:\Users\CARMENCHEAH\Desktop\AmAccess_Biz_Salary.xlsx'. A list of banks is shown, with 'AMBANK [AmAccess Biz - AAB Template]' selected. The 'Recipient Reference' and 'Other Payment Details' fields both contain 'SALARY FOR 202411'. On the right, there are radio buttons for payment frequency: 'Mid Month', 'End Month' (selected), 'Mid and End Month', 'Special Period', 'Bonus Period', 'By Default Cycle', and 'By Weekly'. There are also checkboxes for 'Special' and 'Bonus'. Below these is a 'Company Selection' dropdown menu showing 'DEFAULT'. A small table is visible below the dropdown:

Code	Company
DEFAULT	YEAR END WORKSHOP
YEW	YEAR END WORKSHOP SDN BHD
TSSB	TIMES SOFTWARE SDN BHD

At the bottom, there are buttons for 'Save Setting', 'Process', and 'Close'.

Auto-Setup Employee's Statutory Class

If the following option is enabled under Company Setup > **Miscellaneous**, the system will automatically default the statutory status based on the employee's nationality code.

Company Setup

Profile | Misc Parameter | Prorate Allowance | OT Capping | RestDay Capping | **Miscellaneous**

Document Folder:

☐ Disable Backup/Restore Function

☒ Disable Delete Company Function

☒ PCB By Formula (To create employee income tax history, press the key button)

☒ Include Deduction Code CP39 In (NETT_TAX_Amount) and (X) ?
Applicable for PCB By Formula calculation Only

☐ Include employee monthly SOCSO and EIS (effective 2022) into PCB computation

☒ Auto-Setup Employee's HRD/EPF/SOCSO/EIS Class in Update Employee
Applicable to new employee record creation only

Employee: **B0003** Name: **BALASAMY**

Hired Date: 17/05/2015 9 years 6 months

Birth Date: 24/11/1972 52 years 1 month

Ori. Hired Date:

Pay Type: SN-Mthly Rated-Subj OT

Pay Freq: Monthly

Mid Mth Pay: 0.00 % / 0.00

NRIC: 721124-10-1234

Old IC: A2920056

Passport: PP9865445

Bonus Factor:

Sex: Male Mr

Issued Date:

Basic Salary: 4500.00

Increment: 0.00

Total Wage: 4500.00

Pay Group: STD

☒ Hide Wage

Race: NONE NONE

Nationality: **INDIA** **INDIAN**

Auto-Setup Employee's Statutory Class

Default Values for the following fields in **Update Employee** when creating a new employee profile:

Field Name	Malaysian	Non-Malaysian
EPF Class	CLASS1	NONE
SOCSSO Class	SOCSSO1	SOCSSO1
EIS Class	EIS1	NONE
IC For EPF	New I/C	Passport
IC For SOCSSO	New I/C	SSFW
IC For EIS	New I/C	Passport
IC For Income Tax	New I/C	Passport
IC For Bank	New I/C	Passport
Calculate HRD	Tick	Untick

Note:

An employee will be identified as Malaysian if the nationality code is set to MY, MAL, MALA, MSIA or MYS. It is recommended to use "MY" as the Nationality Code for Malaysians.

Creating New Code in TIMESPAY

The system will restrict the use of special characters when creating new codes in the 'Other Code Table' and 'Allowance/Deduction Table'. You will not be able to type any prohibited characters.

Allowable Special Characters	Allow/Ded Table	Other Code Table
@	Yes	No
\$	Yes	No
&	Yes	No
—	Yes	Yes
-	Yes	Yes
+	Yes	No

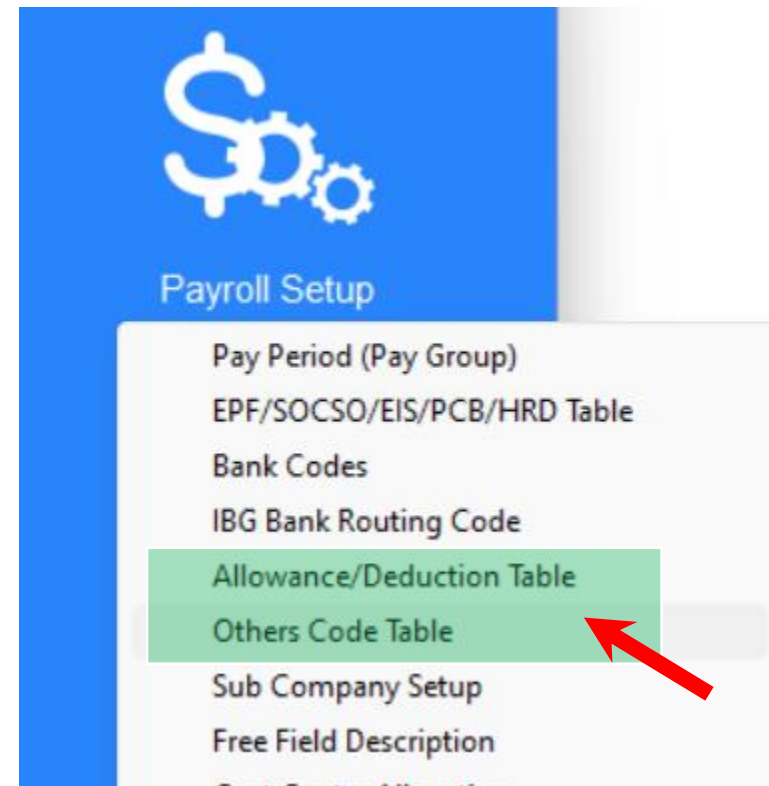

Creating New Code in TIMESPAY

Reasons for the change:

Data Integrity:

Special characters can interfere with database queries, URL encoding, or file system paths, potentially leading to errors or data corruption.

Security:

Special characters may be exploited in code injection attacks, such as SQL injection, cross-site scripting (XSS), or other security vulnerabilities.

End of Presentation
– Thank You!

